

VL-DP

3-JAW SOLID CHUCK WITH ANTI-CHIPS SEALED & WATER-PROOF FLANGE PLATE FOR VERTICAL LATHE

立車用中實油壓夾頭 (含連結板)



尺寸圖 > Dimensions

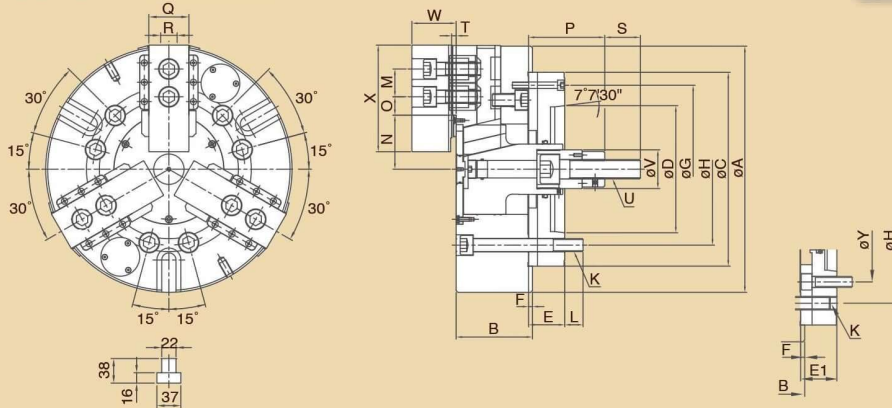

規格表 > Specifications

單位/UNIT:mm

型式/規格 MODEL / SPEC.	主軸鼻端番號 Nose Of Spindle	A	B	C (h6)	D	E	E1	F	G	H	K	L	M
VL-12DP	A ₂ -8(A ₂ -6)	304	110	220	139.719	38	38	6	190	171.4	6-M16x2P	20	30
VL-15DP	A ₂ -11(A ₂ -8)	381	118	300	196.869	54	54	6	260	235	6-M20x2.5P	30	43
VL-18DP	A ₂ -11(A ₂ -8)	450	118	300	196.869	48	48	6	260	235	6-M20x2.5P	26	43
VL-21DP	A ₂ -15(A ₂ -11)	530	129	380	285.775	55	50	6	330.2	330.2	6-M24x3P	36	60
VL-24DP	A ₂ -15(A ₂ -11)	610	129	380	285.775	55	50	6	330.2	330.2	6-M24x3P	36	60
VL-32DP	A ₂ -15(A ₂ -11)	800	129	380	285.775	55	50	6	330.2	330.2	6-M24x3P	36	60

型式/規格 MODEL / SPEC.	N max.	N min.	O max.	O min.	P max.	P min.	Q	R	S	T	U	V	W	X	Y
VL-12DP	60.63	55.32	48.55	20.05	183	153	50	18	36	5	M20x2.5P	50	54	129	133.4
VL-15DP	69.05	60.97	58.05	40.05	136	101	62	25.5	55	7	M30x3.5P	60	68	165	171.4
VL-18DP	99.46	91.38	58.05	40.05	130	96	62	25.5	55	7	M30x3.5P	60	68	165	171.4
VL-21DP	80.49	72.41	101.8	41.8	132	97	65	25	55	7	M30x3.5P	60	75.5	180	235
VL-24DP	119.49	111.41	101.8	41.8	132	97	65	25	55	7	M30x3.5P	60	75.5	180	235
VL-32DP	119.49	111.39	197.8	41.8	132	97	65	25	55	7	M30x3.5P	60	75.5	180	235

型式/規格 MODEL / SPEC.	柱塞行程 Plunger Stroke (mm)	爪行程 〔直徑〕 Jaw Stroke 〔Diameter〕 (mm)	最高迴轉速 Max.Speed r.p.m.(min ⁻¹)	最大拉力 Max. Pull Force kgf (KN)	最大靜夾持力 Max. Gripping Force kgf (KN)	最大設定 油壓壓力 Max. Hydr. Pressure kgf/cm ² (Mpa)	搭配 油壓缸型號 Matching Cylinder	夾持範圍 Gripping Range
VL-12DP	30	10.5	3200	4080 (40)	15500 (152)	29 (2.8)	L1530(L1530RE)	φ18~φ304
VL-15DP	35	16	3000	8260 (81)	25290 (248)	32 (3.1)	L2035(L2035RE)	φ68~φ381
VL-18DP	35	16	2700	8260 (81)	25290 (248)	32 (3.1)	L2035(L2035RE)	φ100~φ450
VL-21DP	35	16	1900	8650 (85)	27000 (265)	33 (3.2)	L2035(L2035RE)	φ80~φ530
VL-24DP	35	16	1700	8650 (85)	27000 (265)	33 (3.2)	L2035(L2035RE)	φ155~φ610
VL-32DP	35	16	1100	8650 (85)	27000 (265)	33 (3.2)	L2035(L2035RE)	φ155~φ800